

---

## CITY OF KELOWNA

# MEMORANDUM

---

**Date:** February 28, 2001  
**File No.:** 0410-01  
**To:** City Manager  
**From:** Wastewater Manager  
**Subject:** Federal / Provincial Infrastructure Grant - 2001 applications

---

### **RECOMMENDATION:**

THAT Council endorse the list of priorities for projects to be submitted for consideration of Grant applications for 2001;

AND THAT staff be directed to prepare and submit applications under the Federal/Provincial Infrastructure Grant program, to the Ministry of Municipal Affairs, for the following projects:

1. Abbott Street revitalization
2. Fitzpatrick area (20A) Sewer Specified Area project
3. McCurdy area (21B) Sewer Specified Area project.

### **BACKGROUND:**

In the spring of 2000, the Federal Government announced that it would direct \$2.65 Billion to create a Grant program to improve and enhance the Infrastructure in Canadian Municipalities. Later that year, an announcement was made that B.C. would be receiving about \$268 Million of that Federal money. The Province announced in October, an \$800 Million Canada/B.C. Infrastructure Grant program, that would be made up of the \$268 Million Federal share, \$268 Million Provincial Funds and the remaining \$268 Million from the benefiting Municipalities/Organizations. The Province of B.C. will be the authority that evaluates and awards the Grants. The Grant program and the allocation of the funds is projected to extend over a 5-year period.

The City of Kelowna has benefited from previous Infrastructure Grant programs. Most recently, the McKenzie bench Sewer Specified area project was awarded a 50% Grant from the Province. Previously, the Poplar Point and Caramillo areas were the recipients of a Federal/Provincial Infrastructure Grant, along with the intersection improvements that were carried out at Spall Rd. and Bernard Ave.

This year, several large projects were evaluated for their benefit to the Community, the Environment and the Health & Welfare of our residents. Three projects are recommended for submission to the Province for consideration of the Canada/B.C. Infrastructure program. The priority of the applications, and a brief description of each project is listed below :

#### **1. Abbott Street revitalization :**

This application is for funds to construct a Recreational Corridor along Abbott Street from Highway 97 south to Christleton, as shown on the attached plan. This project can be

considered as Phase I of a total overall project, which will see the eventual extension of the corridor to Gyro Park. The project will include the following:

1. Replacement of cast iron water mains and wood-stave sewer mains.
2. Improvements to the existing storm sewer system.
3. Construction of two paved driving lanes and a parking lane on the east side of Abbott Street.
4. Construction of a separate paved pedestrian walkway along the west side of Abbott Street and a separate paved bike path which will also be used by skateboarders and rollerbladers along the west side of Abbott Street.
5. Construction of boulevards or barricades between the pedestrian and cycling paths and between the cycling path and the traffic lanes.
6. Installation of traffic calming measures.
7. Installation of heritage lighting features.
8. Planting of trees and shrubs.
9. Development of potential future locations for public art.
10. Installation of general streetscape improvements including such things as benches and waste disposal facilities.

The proximity of Abbott Street to Lake Okanagan combined with the natural beauty of this designated Heritage Area make it a natural draw for the citizens of Kelowna and the large number of visitors we receive every year. The benefits of creating this linear recreation park include the following:

- Upgrades existing infrastructure.
- Discourages commuter traffic from using Abbott Street as their route to downtown.
- Encourages alternate transportation modes.
- Adds greenery to the area.
- Adds to the existing Heritage status of the area.
- Increases access to the beach and to the existing Waterfront and City Park and walkways on the north side of Hwy. 97.
- Lowering traffic speed will improve safety in the area.
- Increases recreational amenity values.
- Provides patients and visitors to the Kelowna General Hospital and the Cancer Clinic with safe access to our park and walkway system.

Abbott Street has the potential to play an important role in the City as a destination recreation place and corridor for all age groups. The estimated cost of all the components of the Abbott Street revitalization is approximately \$5.2 Million.

**2. Fitzpatrick area (20A) Sewer Specified Area project :**

**3. McCurdy area (21B) Sewer Specified Area project :**

The Fitzpatrick and McCurdy trunk sewer service areas, shown on the attached map, make up the most Northern portion of the built-up area of Rutland. The Fitzpatrick area consists of approximately 1000 dwelling units and the McCurdy area consists of approximately 1500 dwelling units that are presently utilizing septic disposal fields to dispose of their wastewater.

The Fitzpatrick Service Area presently has the highest Sewer Service Area fees of all the areas in Rutland, which is one of the reasons this area is suggested as the top priority of Sewer projects to obtain financial assistance. The current rate in the Fitzpatrick area is \$11,000 per Dwelling Unit. There are a few reasons for the higher per-unit cost, namely:

- The area is not densely developed, resulting in the costs of sewerage the area being apportioned between a small number of benefiting property owners, which increases the per-unit cost.
- The area includes the Graf and Hayashi neighbourhoods on the Rutland Bench, which are a long way from the built-up area below, requiring long distances of sewer main to service a small number of homes. The hillside neighbourhoods are also more expensive to service.

If an Infrastructure Grant is obtained for the proposed portion (Spec. Area 20A) of the Service Area, the financial assistance will substantially reduce the cost of sewerage that area and will also then reduce the costs for the balance of the Service Area. The proposed boundary for this Spec. Area is attached, and the estimated cost of the project is approximately \$3.3 Million.

The McCurdy Sewer Service Area is a substantially built-up area of Rutland that remains unsewered. The proposed Specified Area (No. 21B) is a portion of the total service area and will result in the installation of a sewer system for some of the most problem prone neighbourhoods in the area. The Service Area fees in Area 21 are moderate at \$6,700 per Dwelling Unit, and will be reduced further if a Grant is obtained. In addition, if the proposed McKenzie Bench Spec. Area for which we have already received a Grant is successful, the Sewer Service Area fee will again be reduced. However, the largest number of people, with the greatest need, will be sewerage if this application is successful. The estimated cost of Spec. Area No 21B is approximately \$3.6 Million and the anticipated area it will cover is indicated on the attached map.

Based on the number of inquiries and requests for sewer service that staff has received, the neighbourhoods contained in both the proposed Spec. Areas appear the most in need in the Rutland Area. Recently, in an attempt to quantify the extent of the septic problems, questionnaires were mailed to residents in the affected areas. The results of the questionnaires are as follows :

- In the proposed Fitzpatrick Spec. Area (No. 20A), 240 questionnaires were mailed out and as of the date of this report 79 were returned. Of the questionnaires returned, 21 owners representing 27%, indicated that they had experienced septic system problems, and 50% expressed a desire for the City to pursue a Sewer installation project in their area. The numbers are not as significant as anticipated, and it is speculated that the present Sewer Service Area fee of \$11,000 per EDU may be causing owners to resist the suggestion of proceeding with a Sewer installation project.
- In the proposed McCurdy Spec. Area (No. 21B), 560 questionnaires were mailed out and as of the date of this report 163 were returned. Of the questionnaires returned, 33 owners representing 20%, indicated that they had experienced septic system problems, and 60% expressed a desire for the City to pursue a Sewer installation project in their area.

Although the Grant applications will be submitted to the Province with suggested priorities, the Ministry of Municipal Affairs has a matrix that they use to determine the priorities that they will award Grants with. It is possible that the Province may award an Infrastructure Grant to one or more of the lower priority projects.

---

W.J. Berry, P.Eng.  
Wastewater Manager

---

John Vos  
Director of Works & Utilities

# Abbott Street Recreational Corridor Highway 97 to Christleton Av.

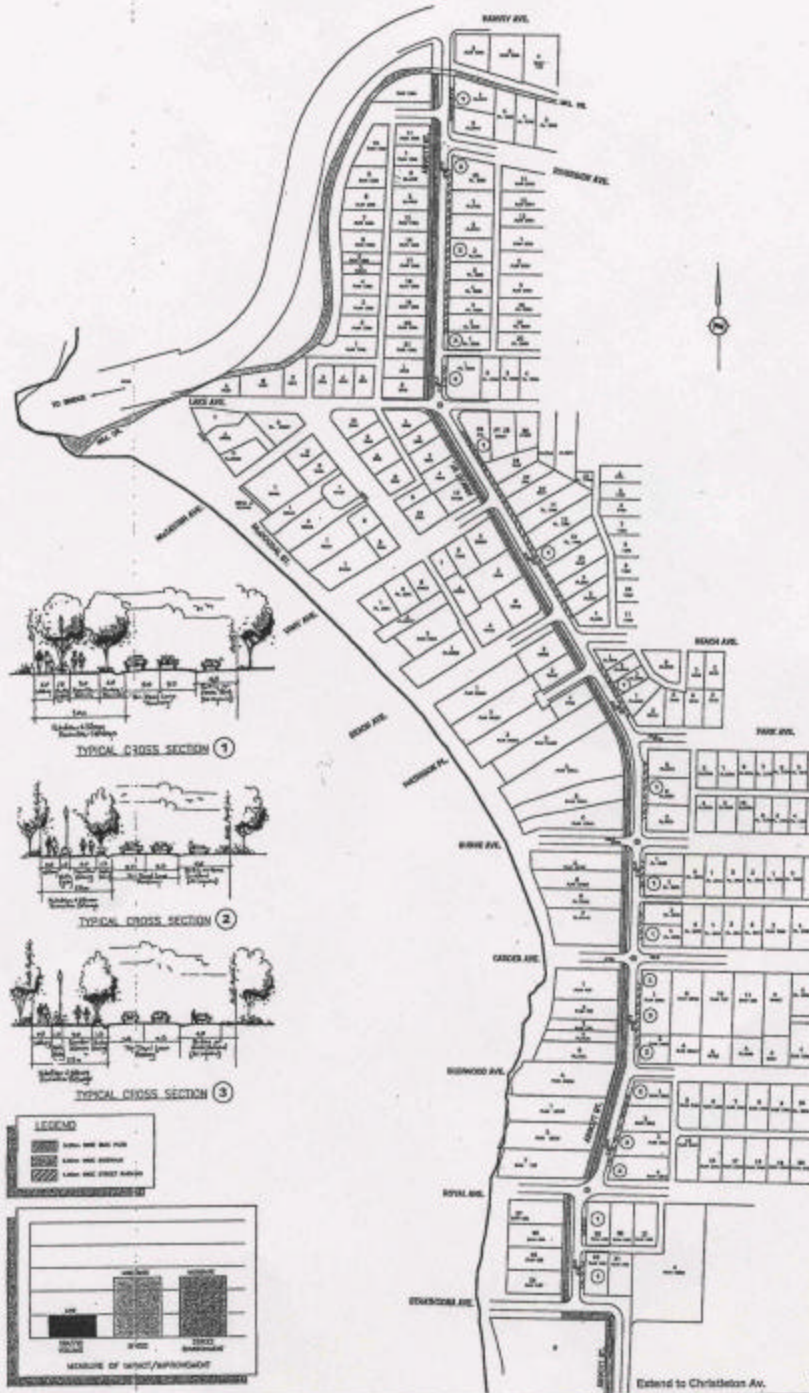

**OPTION 2 - MODERATE TRAFFIC CALMING**

**GOAL** TRAFFIC CIRCLES  
ENHANCED PEDESTRIAN  
AND CYCLIST ENVIRONMENT

SCALE: 1:500



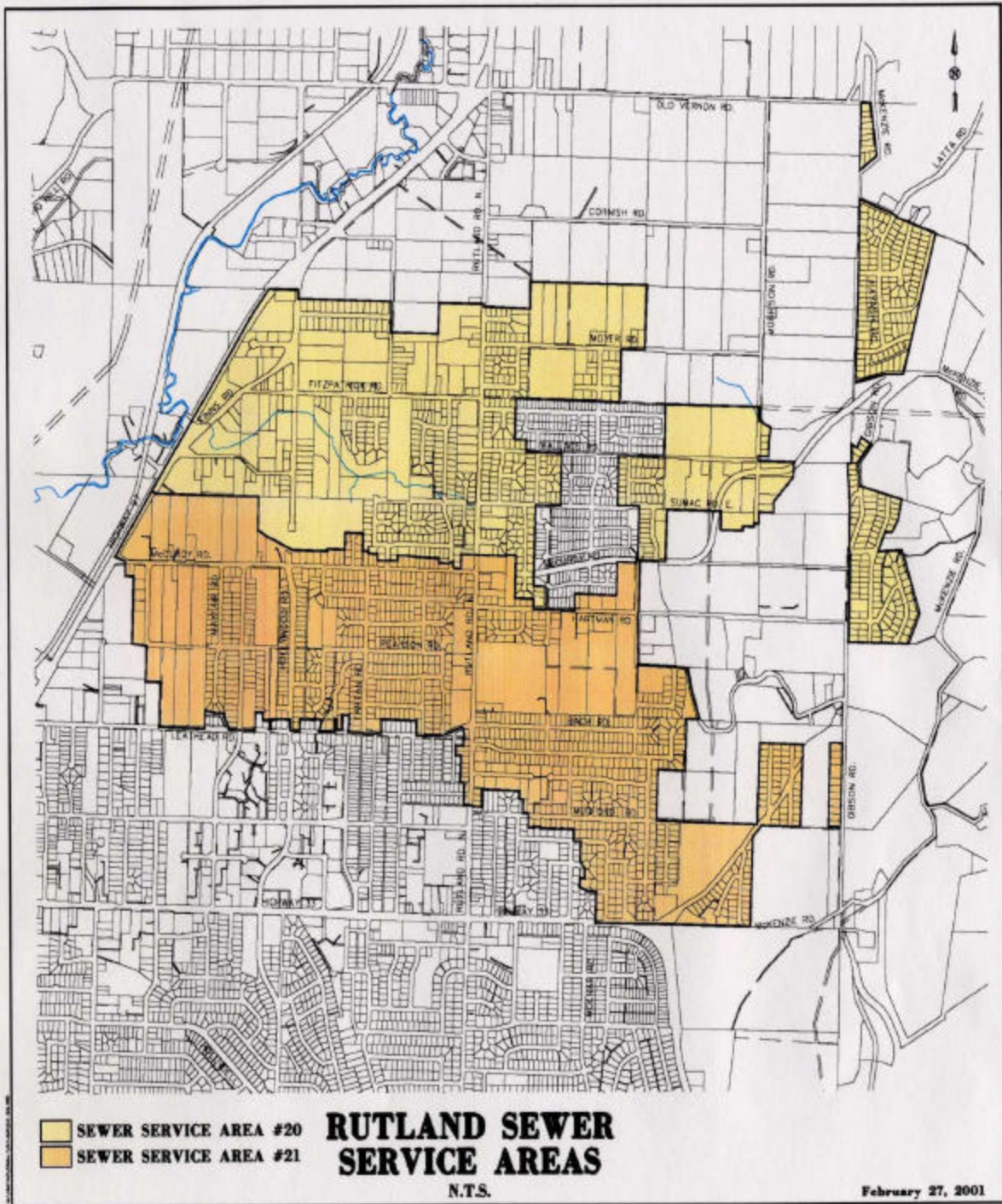

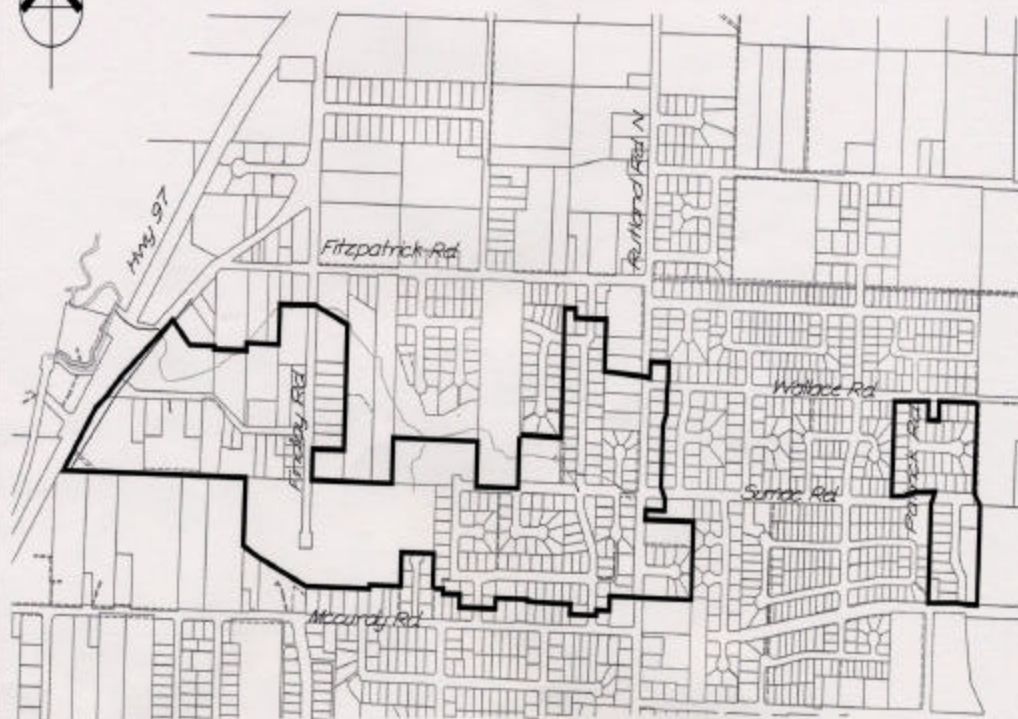



**Proposed Sanitary  
Sewer Area 20A**  
**CITY OF KELOWNA**  
**WORKS AND UTILITIES**

IN VIVO CYTOTOXICITY TESTING OF A DNA VACCINE

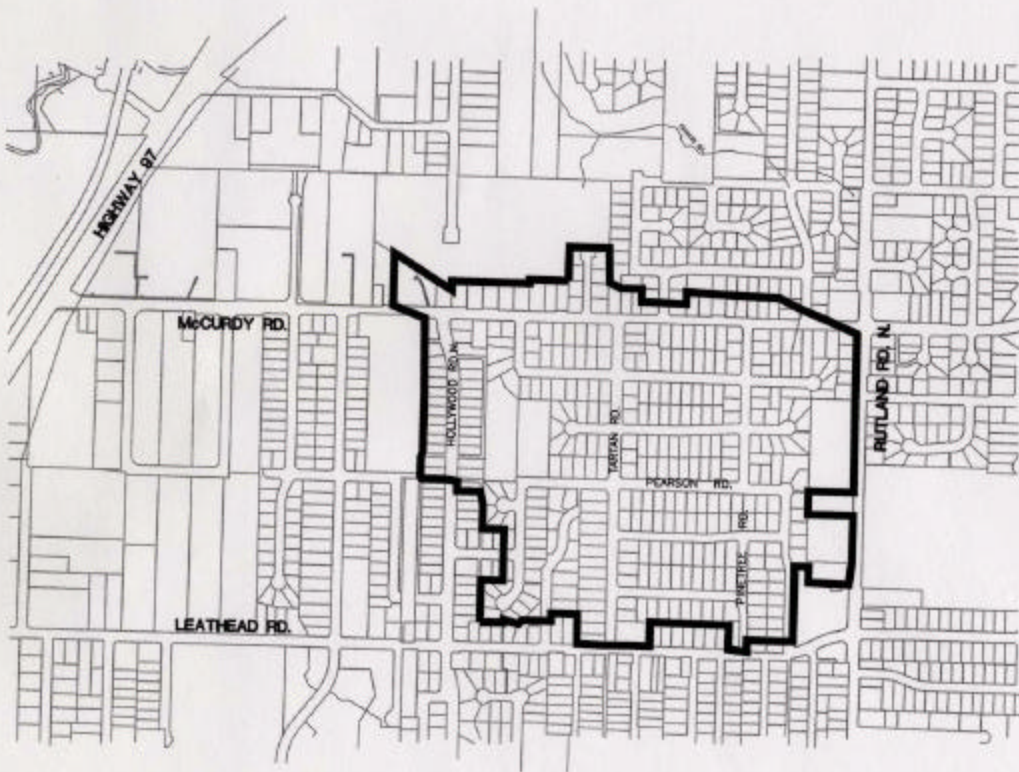



Proposed Sewered Area 

BL/WU/DRAFTING/MISC/DWG/SSA21B

DRAWN GT	DATE FEB. 25/01	THE CITY OF KELOWNA ENGINEERING DEPARTMENT  <b>SEWER SPECIFIED AREA 21 B</b>	DIVISION WORKS & UTILITIES	
DESIGN	SCALE		DWG. NO.	REV. NO.
APPROVED	NTS			